

>swan

Swan (cold white)	OUTDOOR USE
Swan (warm white)	OUTDOOR USE

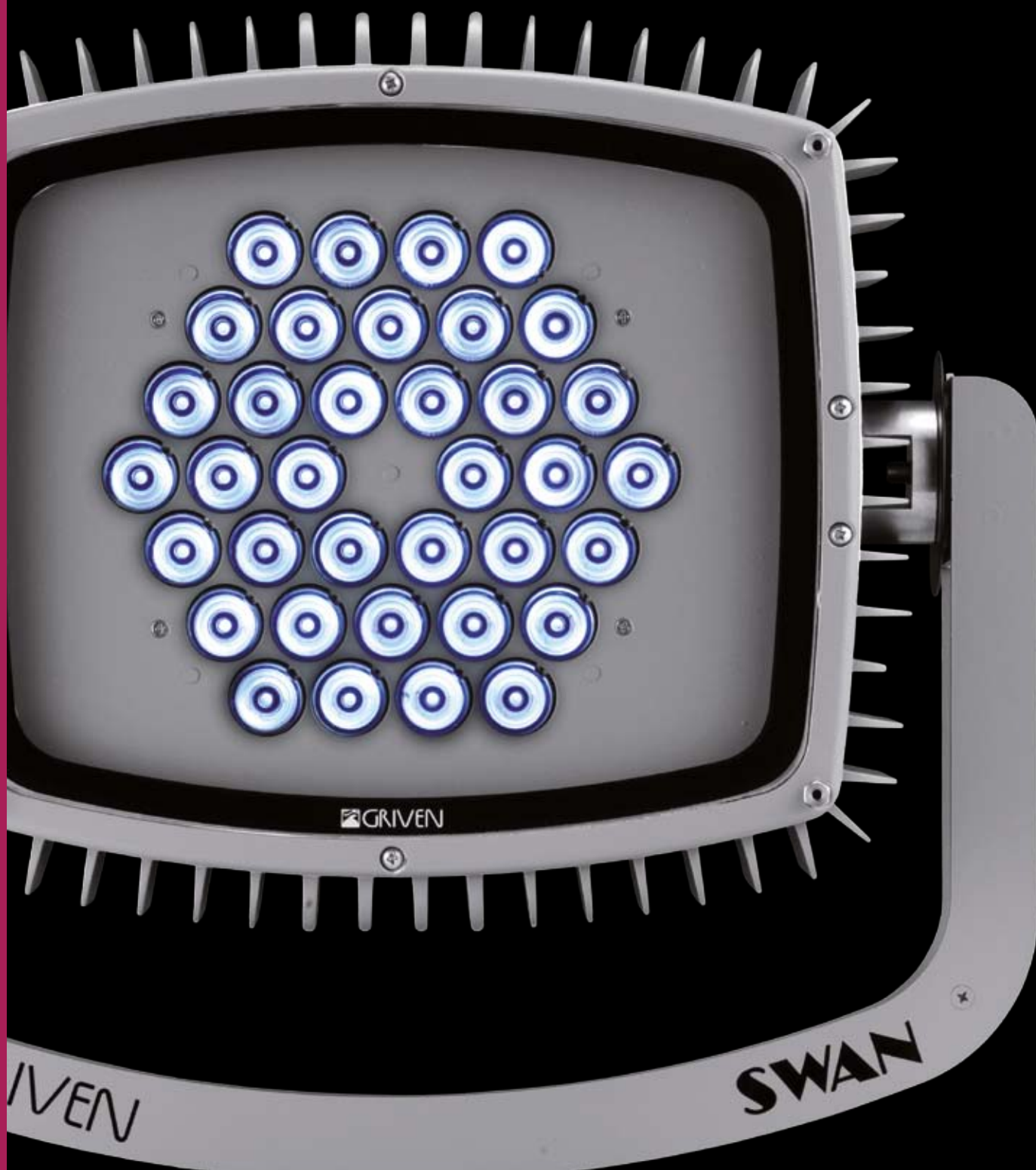



SWAN is an efficient general purpose white light LED floodlight that uses thirty-six 2,4W bright white LEDs. Fitted with the highest precision technology and the latest software developments, the LEDs utilized have been coupled with the most effective lenses to give an incredibly homogeneous daylight white output. The unit can be customized with a choice of 10°, 30° or 45° lenses to suit additional requirements of alternative beam creations, always preserving the highest luminous efficacy. SWAN is also available both with 3200K and 6500K white light to meet any design specification. The extruded aluminium body is equipped with heat sink fins for an optimized thermal management and the enhanced silent operation is conveyed by the use of magnetic levitation motor fans. SWAN's environmental impact is really small with no ultraviolet radiation and infrared emanation, an exceptionally low power consumption and a drastically reduced maintenance requirement, where the life of the light source is remarkably extended compared with any other conventional lighting equipment and no lamp replacement is requested. Wall, ceiling or surface mounting can be comfortably achieved by the built-in fixing yoke and the optional display plate. The compact outline features a robust and durable extruded aluminium housing certified to an IP65 weather protection for the widest variety of applications such as accent, display, effect and landscape lighting.

AL1610	SWAN COLD WHITE 10
AL1612	SWAN COLD WHITE 30
AL1614	SWAN COLD WHITE 45
AL1710	SWAN WARM WHITE 10
AL1712	SWAN WARM WHITE 30
AL1714	SWAN WARM WHITE 45

ACCESSORIES



AL1620
10° LENSES OPTIC GROUP

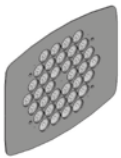

AL1622
30° LENSES OPTIC GROUP

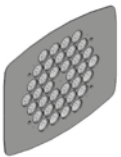

AL1624
45° LENSES OPTIC GROUP

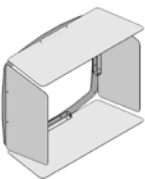

AL1616
BARNDOOR SET



AL1618
FIXING PLATE



GR0250
SAFETY CABLE

TECHNICAL SPECIFICATIONS

SOURCE

36 high brightness, 2,4W, WHITE power LED (Light-Emitting Diode) units
No UV / no infrared
Virtually instant light production (100 ns)

SOURCE LIFE

The LEDs used have an exceptionally long life: predicted 100.000 hours under normal operating conditions as mentioned by the LED manufacturer.

OPTICS

10° lenses fixture cold white (ordering code AL1610) 6500K
30° lenses fixture cold white (ordering code AL1612) 6500K
45° lenses fixture cold white (ordering code AL1614) 6500K
10° lenses fixture warm white (ordering code AL1710) 3200K
30° lenses fixture warm white (ordering code AL1712) 3200K
45° lenses fixture warm white (ordering code AL1714) 3200K
Optional 10° lenses optic group (ordering code AL1620)
Optional 30° lenses optic group (ordering code AL1622)
Optional 45° lenses optic group (ordering code AL1624)

ELECTRICAL SPECIFICATIONS

Power supply:
standard 200-220V / 230-250V / 50-60Hz / 1A @ 230V
optional 90-120V / 50-60Hz / 2A @ 110V
Power Consumption: 140W
Electrical class: I
Meets CE safety standards

HOUSING

IP65 extruded aluminium body with all-round heat sink fins
Scratch resistant polyester grey finish, protected against UV deterioration and general corrosion
Front tempered glass shock resistant
Internal cooling system equipped with magnetic levitation motorized fans for virtually noiseless operation
Certified IP65 protection rating for the most severe weather conditions
Adjustable mounting yoke (3 holes Ø 12 mm)

OPERATING LIMITS

-20°C to 40°C (-4°F to 104°F) temperature

WEIGHT

15,5 kg

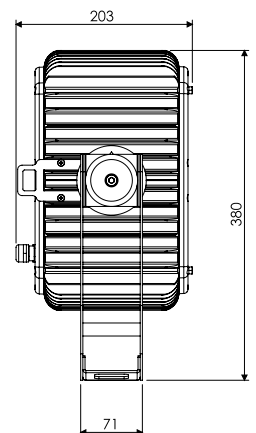
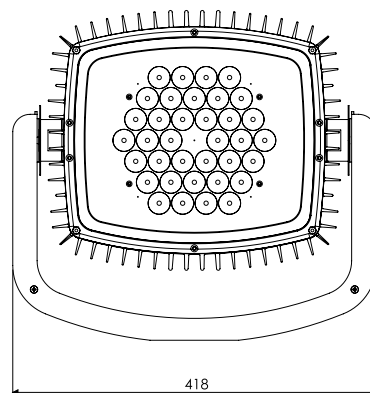
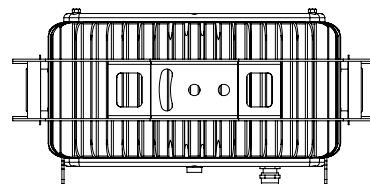

PHOTOMETRIC DIAGRAMS

AL1610
AL1710

Total flux 3600 lm
Maximum 13135 cd/Klm

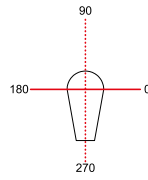
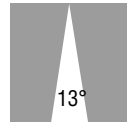

— C0 / C180
- - - C90 / C270
cd / 1000 lm

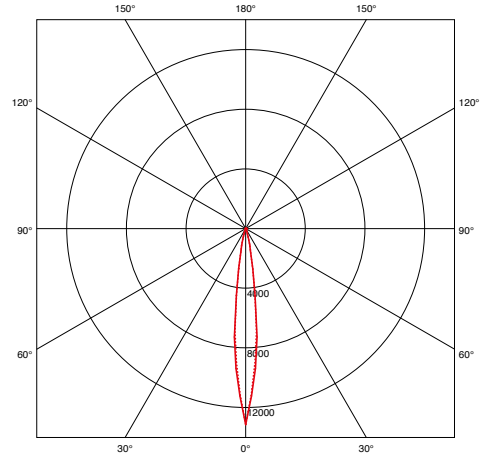

AL1612
AL1712

Total flux 3600 lm
Maximum 3618 cd/Klm

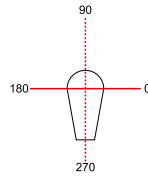
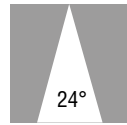

— C0 / C180
- - - C90 / C270
cd / 1000 lm

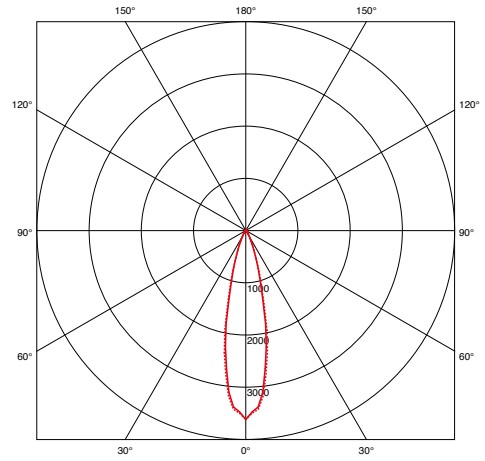

AL1614
AL1714

Total flux 3600 lm
Maximum 1346 cd/Klm

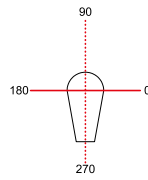
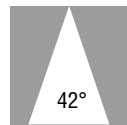

— C0 / C180
- - - C90 / C270
cd / 1000 lm

